

Robo Swing R900™ / Robo Slide™

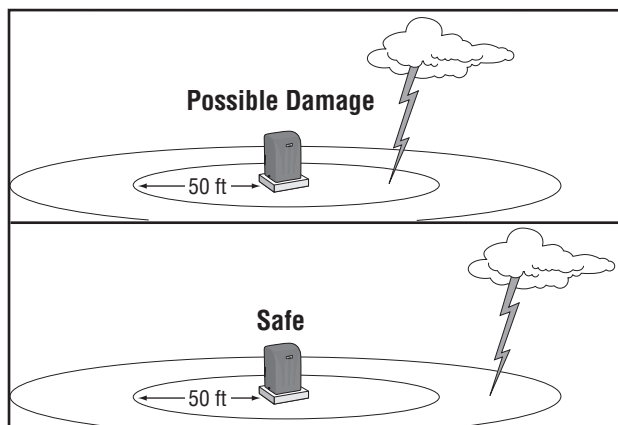

surge suppression installation manual

Please read this entire manual before installation



Important!

! The green ground wire **must** be securely connected to the chassis

Note: Plate For Use with Roboswing Only!

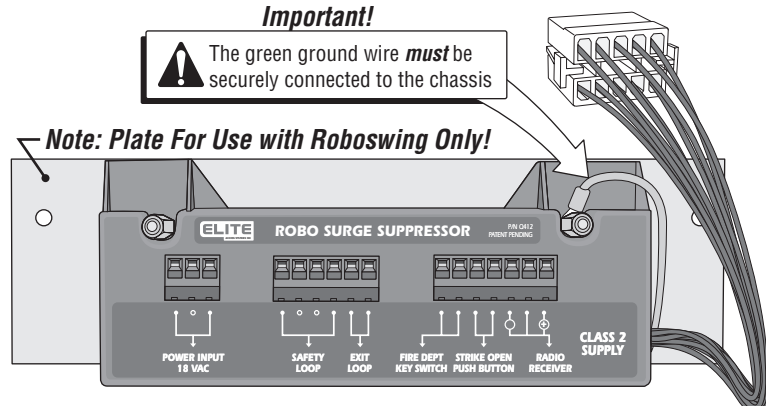

Inputs protected by the Surge Protection Module.

Name of Lines Protected	Number of Lines Protected
Safety Loop Command	1
Exit Loop Command	1
Fire Department or Key switch	1
Strike Open or Push Button	1
Radio Receiver (Power and Relay) Power Input (18 Vac)	3
Ground	2

Earth Ground Rod Installation

Proper grounding gives an electrical charge, such as from an electrical static discharge or a lightning strike, a path from which to dissipate its energy safely into the earth.

Without this path, the intense energy generated by lightning could be directed towards the gate operator. Although nothing can absorb the tremendous power of a direct lightning strike, proper grounding can protect the gate operator in most cases.



Before digging more than 18" deep, contact local underground utility locating companies
Avoid damaging gas, power, or other underground utility lines.



The earth ground rod **must** be located within 3 feet from the gate operator. Use the proper type earth ground rod for your area.

The ground wire **must** be a single, whole piece of wire. **Never** splice two wires for the ground wire. If you should cut the ground wire too short, break it, or destroy its integrity, replace it with a single wire length.



Not responsible for improper installation or failure to comply with all necessary local building codes.

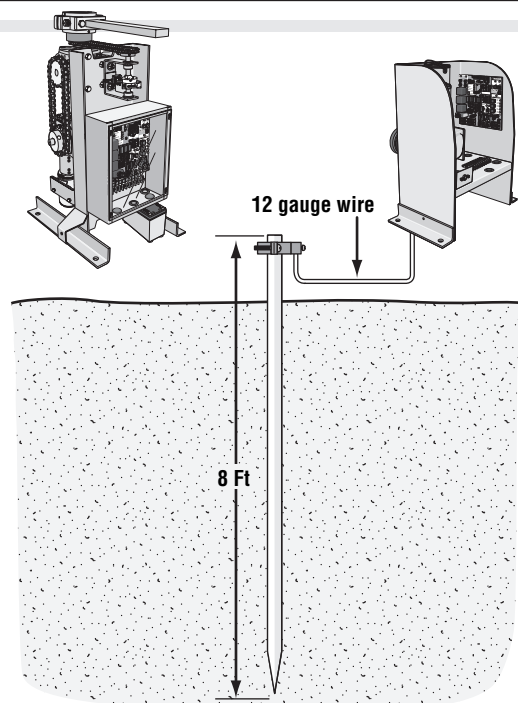

© 2004 The Chamberlain Group, Inc.
All Rights Reserved

CHAMBERLAIN®

ELITE™

845 Larch Avenue Elmhurst, Illinois 60126
www.chamberlain.com

For Technical Support: 1-800-528-2806

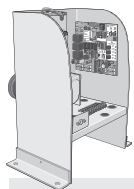

Robo Slide™ Surge Suppressor Step-by-Step Installation

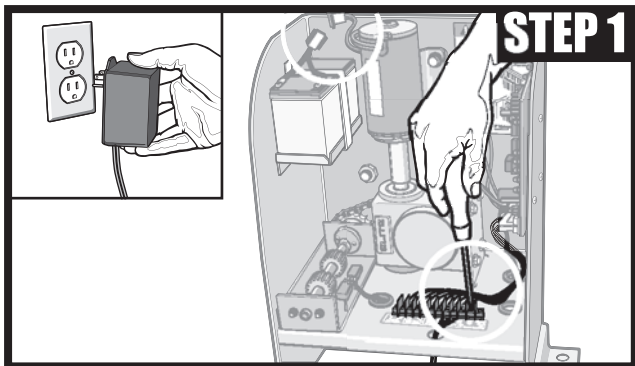

Unplug the power transformer, battery connection and all accessory wires from terminal block.

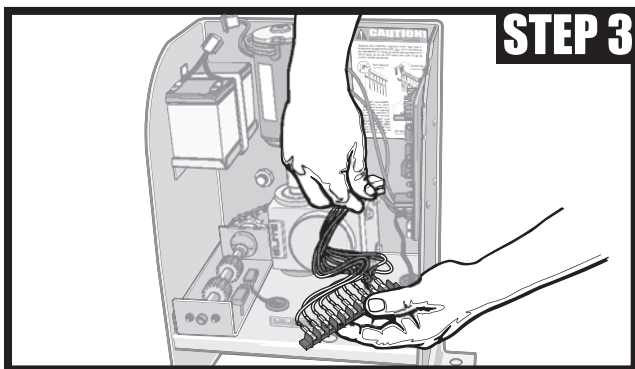

Unplug the J1 socket and remove the old terminal block.

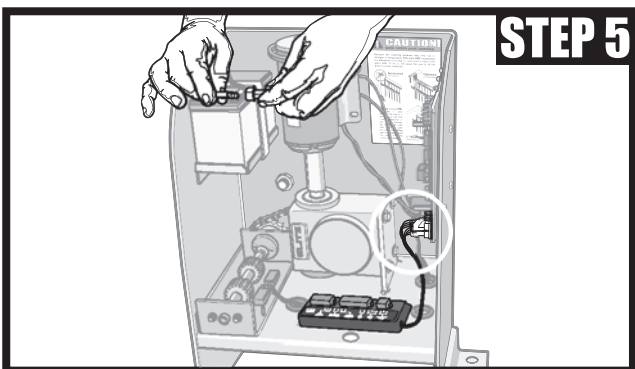

Plug the surge suppressor's J1 plug into control board and reconnect battery.

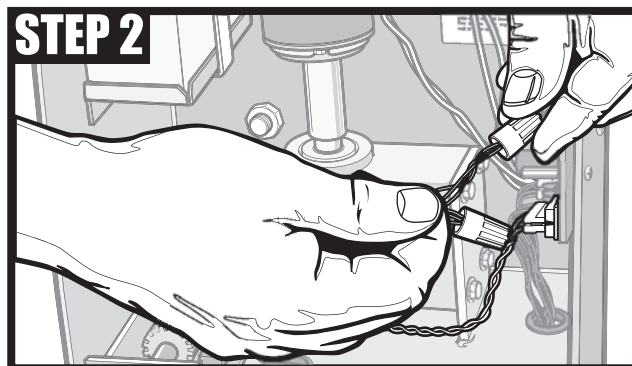

Disconnect yellow power transformer wires from J1 plug.

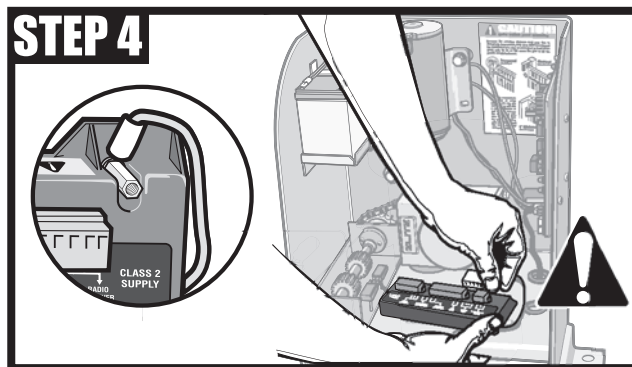

Mount surge suppressor in same place as old terminal block.
Connect green ground wire to the chassis. DO NOT USE METAL PLATE

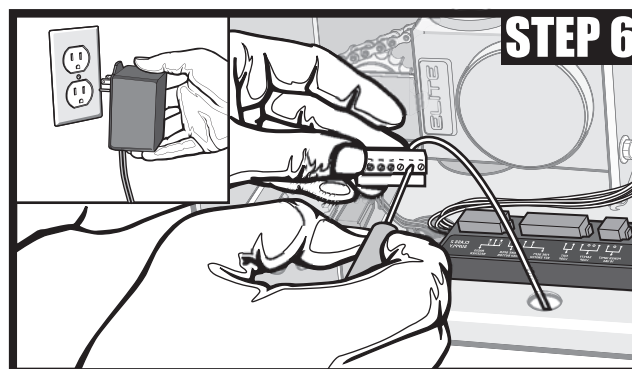

Reconnect all accessory and power wires to surge suppressor module. Plug transformer back in.

Test all the accessories in combination with the gate operator to corroborate proper installation and functionality.
See wiring diagram on back.

For Technical Support: 1-800-528-2806

CHAMBERLAIN®

ELITE™

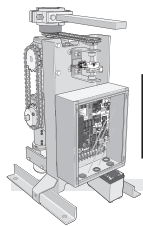

Robo Swing R900™

Surge Suppressor Step-by-Step Installation

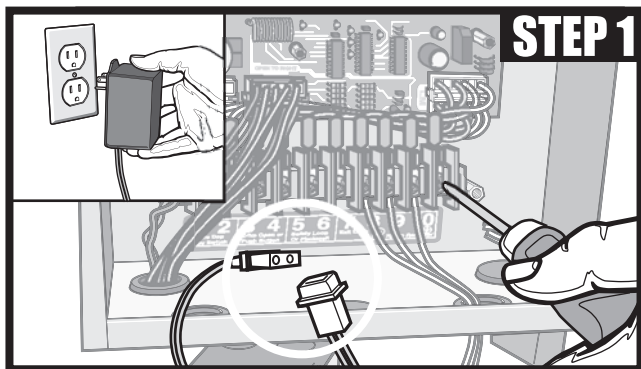

Unplug the power transformer, battery connection and all accessory wires from terminal block.

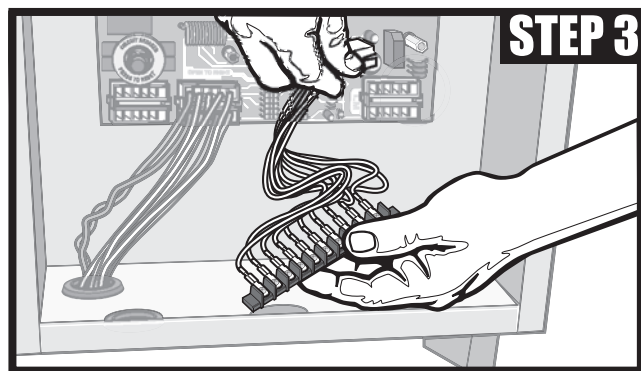

Unplug the J1 socket and remove the old terminal block.

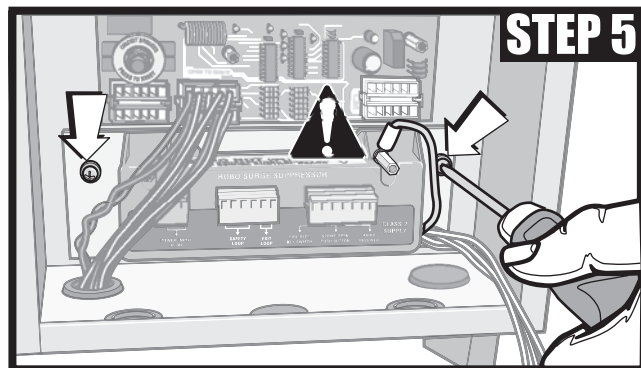

Remove the two lower screws holding electronic box to chassis and mount the surge suppressor **with plate** in the electronic box with the two screws. **Make Sure Green Ground Wire Makes Good Contact With Chassis.**

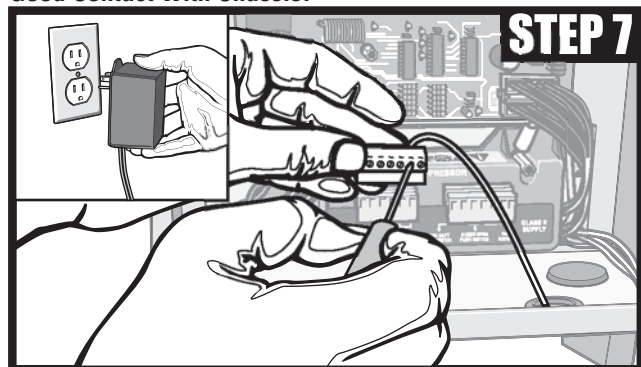

Reconnect all accessory and power wires to surge suppressor module. Plug transformer back in.

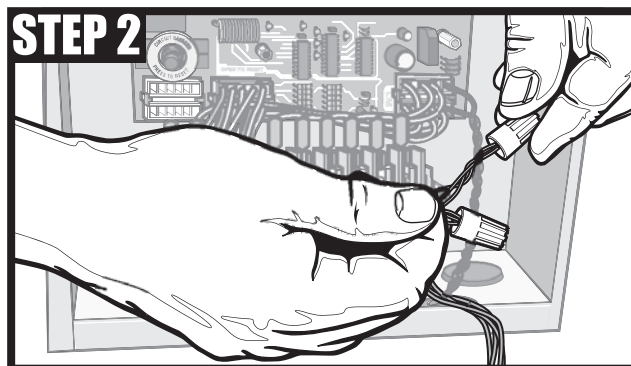

Disconnect power transformer wires from J1 plug.

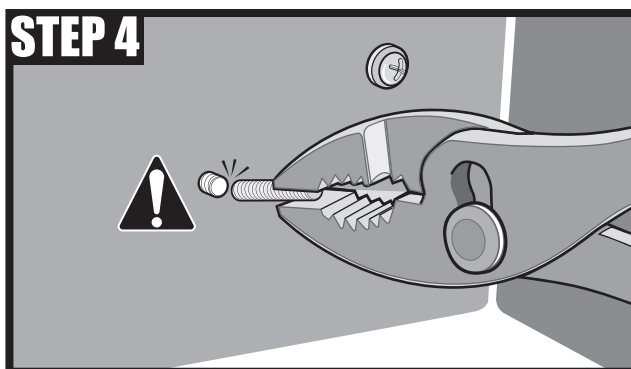

Carefully break off the 2 studs that held the old terminal block. **DO NOT use hammer!**

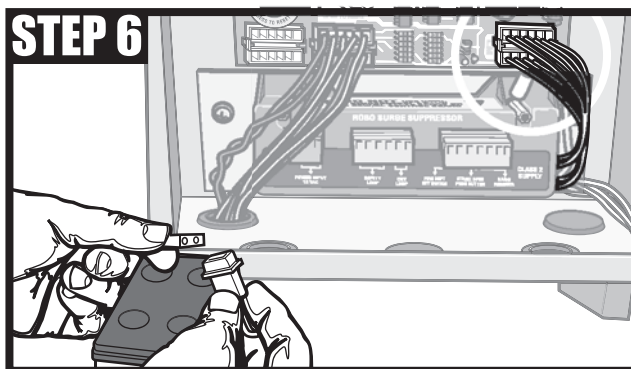

Plug the surge suppressor's J1 plug into control board and reconnect battery.

Test all the accessories in combination with the gate operator to corroborate proper installation and functionality. See wiring diagram on back.

For Technical Support: 1-800-528-2806

Additional Protection Against Surges for Gate Operators

For additional protection against surges, ensure that the cables or wires going to your accessories comply with the following rules:

All wires going to the accessories *must* be shielded wires.

The shield *must* be connected as follows:

- A) At the gate operator: To the chassis of the gate operator
- B) At the accessories: To their chassis (Earth grounding at the accessories will be even more beneficial)

Ensure that the connections to the chassis are made as tight as possible to create good contact.

Ground Wire Must Make Good Contact With Chassis

